

Full-view THERMOMETER

Please read the following notice carefully before using, install and operate the meter correctly.

1 Precautions

1. Please use the product accordance with the user guide strictly.
2. Please do not dismantle the product by yourself.
3. Due to the waterproof design of the product, it can be used in the rain, but can not be put into in deep water.
4. When the product is in the intense vibration or strong impact. It will cause a failure.
5. The product must be used within the specified range of voltage.
6. The backlight function will need more battery level, battery life is limited ,when the battery level is low, please replace the battery as soon as possible. The battery item is CR2032.

2 Installation

1. How to install the battery.

【Notice】 :The original data will be retained after replace battery.

- 1 Unscrew the four screws in the cover

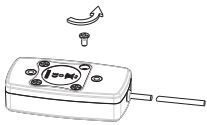

Use a screwdriver to counter clock wise twist, then unscrew the screws

- 2 Open the battery cover

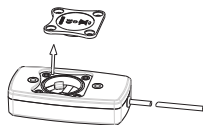

Remove the battery cover from the product

- 3 Put the battery inside

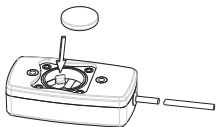

Smooth side should be put upward

- 4 Close battery cover, and tighten the screws

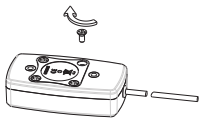

Use a screwdriver to clockwise twist , then tighten the screws.

2. How to install the product.

Note: There are three ways, you can choose the one you needed.

- 1 When using double-sided tape, stick one side on the back of the product, stick another side on the machine.

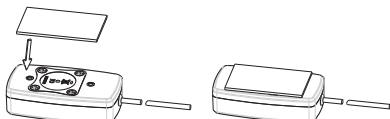

- 2 When using screws, proceed in the following order

- a) Fasten the two M3 bolts on the product;
- b) Mount the bolts into the fixed plate holes;
- c) Insert M3 gasket and fasten with M3 screw nut to the fixed plate.

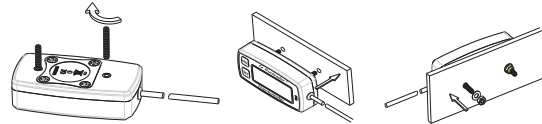

Notice: The mounting plate is required matching holes, if don't have it, please drill corresponding holes in the mounting plate.

- 3 When using aluminum frame, proceed in the following order

- a) Fasten the aluminum frame with M6 screws into the mounting plate ;
- b) Fasten the aluminum frame and product with M3 screws.

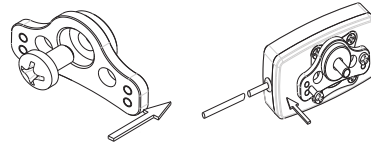

Notice: This product does not include the aluminum frame.

- 4 Connect the product wire and temperature sensor as below picture.

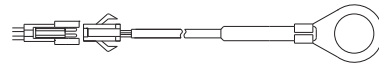

- 5 Put the end of the sensor into the products which to be tested.

3. Check the correctness of the product installation.

Access to the sensor, if temperature data is displayed, which means the product was installed correctly.

3 product application

1. View the working data.

When the product is in the state with backlight, short press the **MENU** button, you can view "over temperature reminded value, the maximum tested temperature value, temperature unit, sensor type and instant temperature value" in turn.

【Notice】 : When the product is working without backlight, short or long press any button to make the product in the backlight.

2. Set the temperature reminder value.

- 1 In the temperature reminder value interface, long press the **MENU** button more than 2 seconds, then enter into the temperature reminder value setting interface, the default value is "100 °C".

② In the temperature reminder value setting interface , long or short press **SET** button to add the setting value, long or short press **MENU** button to reduce the setting value. The setting value range is from - 20 °C to + 300 °C (-4 °F - + 572 °F).

③ After setting, press the **MENU** button and **SET** button together more than 2 seconds, then confirm and exit the setting interface.

④ When the product is working,if the current temperature is higher than the temperature reminder value, the warning signs will flash in the instant temperature interface.

3. Reset the maximum temperature.

In the maximum temperature interface,press the **MENU** button more than 2 seconds, the current max temperature value will be reset,the reset value is - 20 °C (-4 °F).

4. Set the temperature unit.

① At the temperature unit view interface,long press the **MENU** button more than 2 seconds,then enter into the temperature unit setting interface,the temperature unit symbol will flash. The default of temperature unit is "c".

② After entering the setting interface, short press the **SET** button or **MENU** button to select the temperature unit (°C or °F).

③ After setting, long press the **MENU** button and **SET** button together more than 2 seconds, then confirm and exit the setting interface.

【Notice】 : After switching the temperature unit, the original temperature reminder value will have a small changes.

5. Battery level display.

① Battery level is displayed as below:



② When the battery voltage is empty, it will flash to remind you to change the battery.

6. When the product is in any working condition, such as in setting interface or view interface, if no operation more than 10 seconds, it will switch to the current temperature display interface automatically.

4 Product parts list

Specification-----1 Magic tape-----1 Zip tie-----2
Temperature sensor(PT100)-----1

5 Product Technical Parameters

Temperature range	-20 - +300°C(-4°F-+572°F)
Temperature accuracy	±1% °C(°F)
Refresh rate	6s
Canning material	ABS
Waterproof	IP67
Display mode	22×44mm LCD
Display window size (visible)	18×42mm
The temperature sensor line length	60cm
Product weight	84g
Product size	67×35×17mm
Battery specifaion	CR2032 210MAH

6 Troubleshooting

Problems	Possible reason	Solution
The window screen no display	1.Is the battery empty . 2.The battery installation is wrong.	1.Replace a new battery. 2.Check if the battery installation is correct or not.
LCD screen display err	1.Sensor is not installed in the right way. 2.Sensor is damaged.	1.Reinstall the sensor. 2.Change the new sensor.
Display no change	Disturbed crash.	Install the batteries again.
LCD screen display is not clear or discoloraton	1.Angle wrong. 2.Lack of battery.	1.Adjust angle. 2.Replace battery.